

Wall Mount instructions For R2-D2 – (75379)

Kit Contents:

- A. 1x Left Arm
- B. 1x Right Arm
- C. 1x Wall Stretcher
- D. 2x Lower frame
- E. 2x Upper frame
- F. 1x Minifigure mount
- G. 1x Minifigure mount cleat
- H. 2x Wall screws
- I. 2x Wal plugs

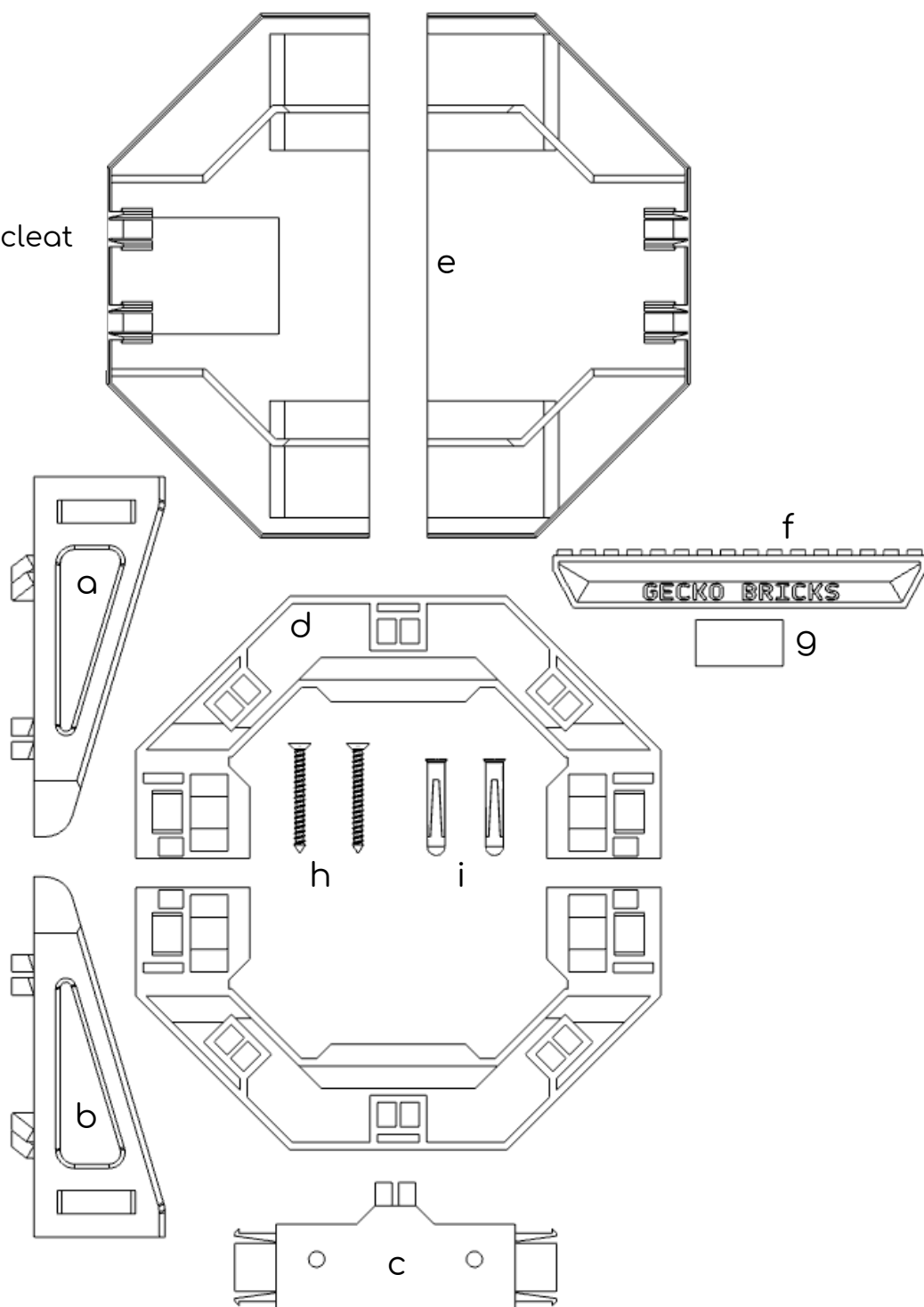

Wall Mount instructions For R2-D2 – (75379)

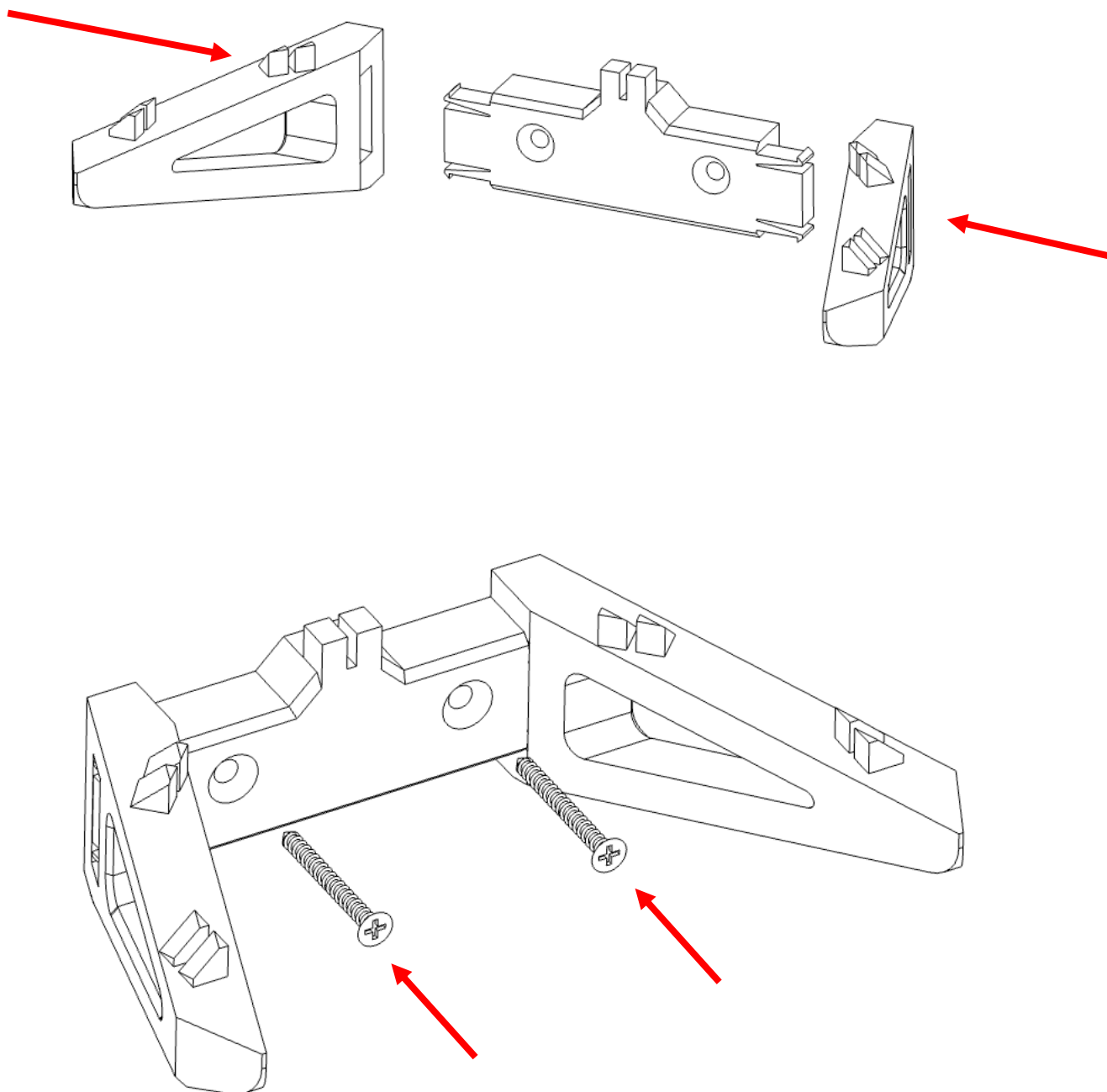

Use the provided wall fixings to secure to the wall. Do not over tighten the screws (use a screwdriver only).

Wall Mount instructions For R2-D2 – (75379)

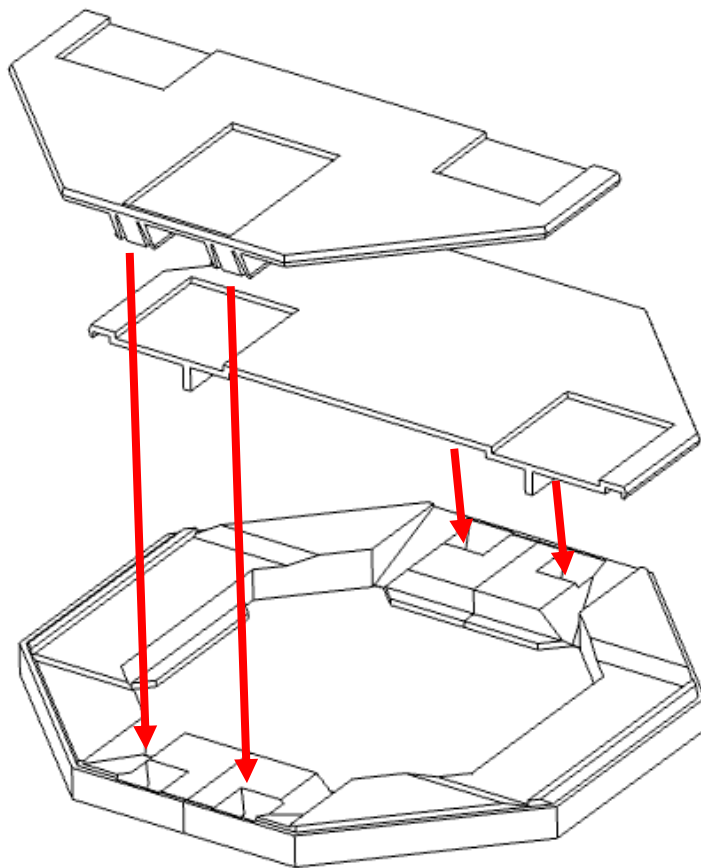

You can orientate the set to face angled either left or right by fitting the frame in at a 45 degree offset.

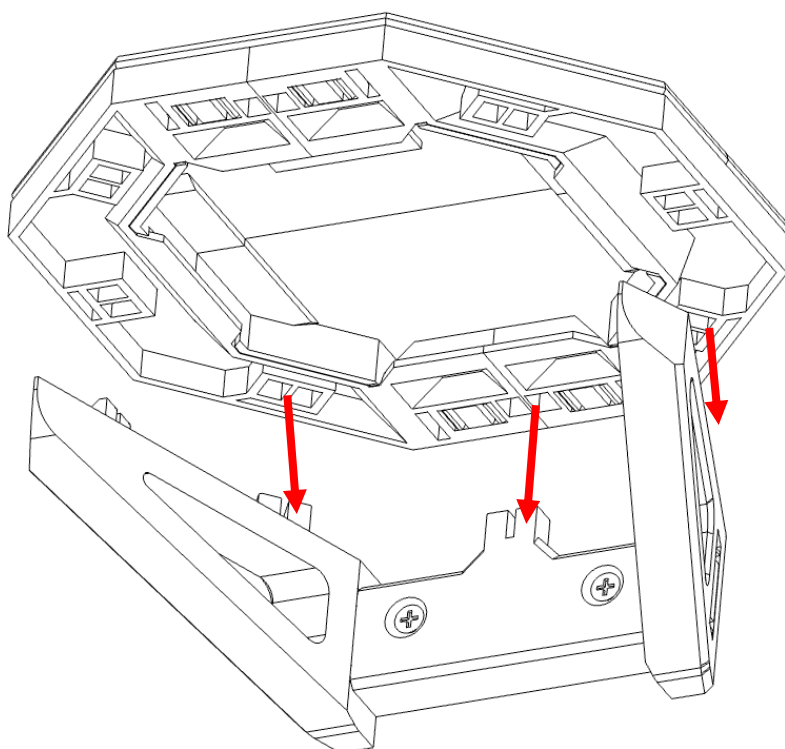

Wall Mount instructions For R2-D2 – (75379)

Secure the Minifigure mount cleat to the wall first using the included 3M command strip. Please allow at least an hour for the Command strip to fully adhere. Then sit the Minifigure mount onto the cleat.

