

Wall mount Instructions For Back to the Future Time Machine – (10300)

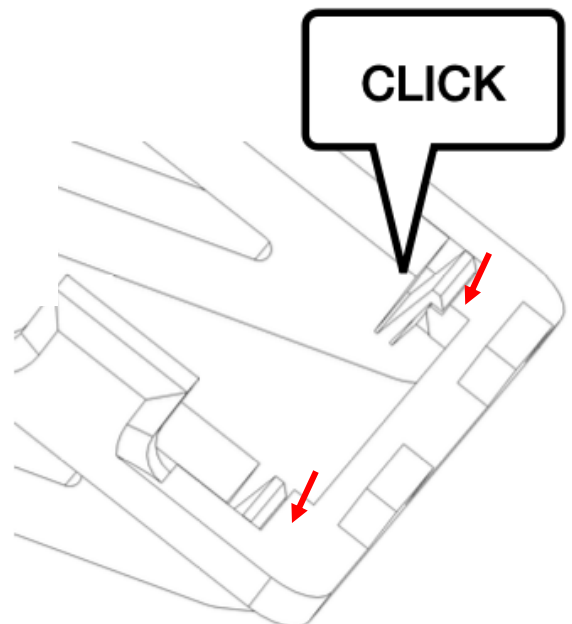

Wall mount Instructions For Back to the Future Time Machine – (10300)

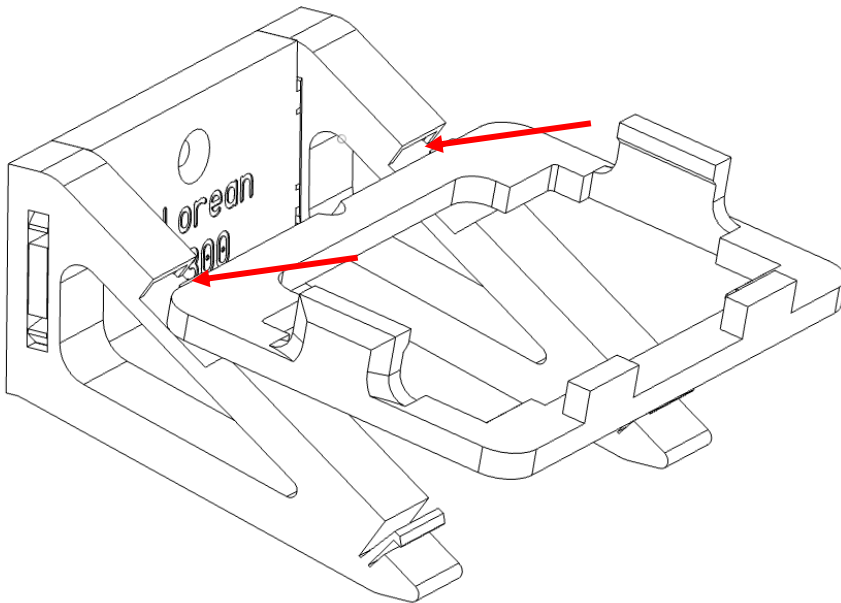
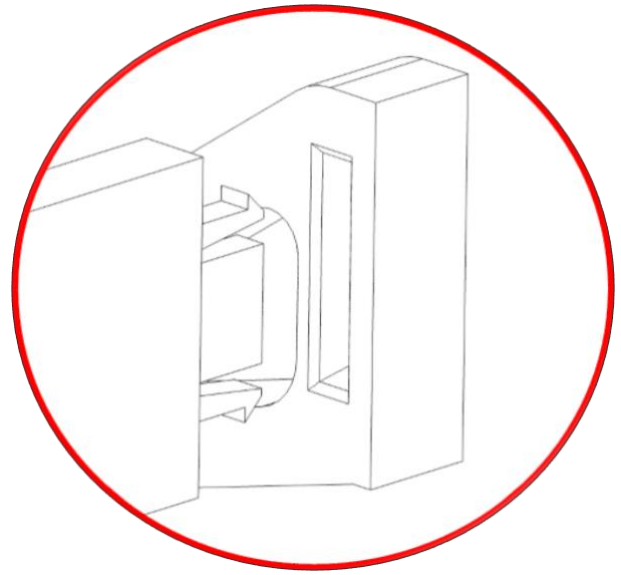
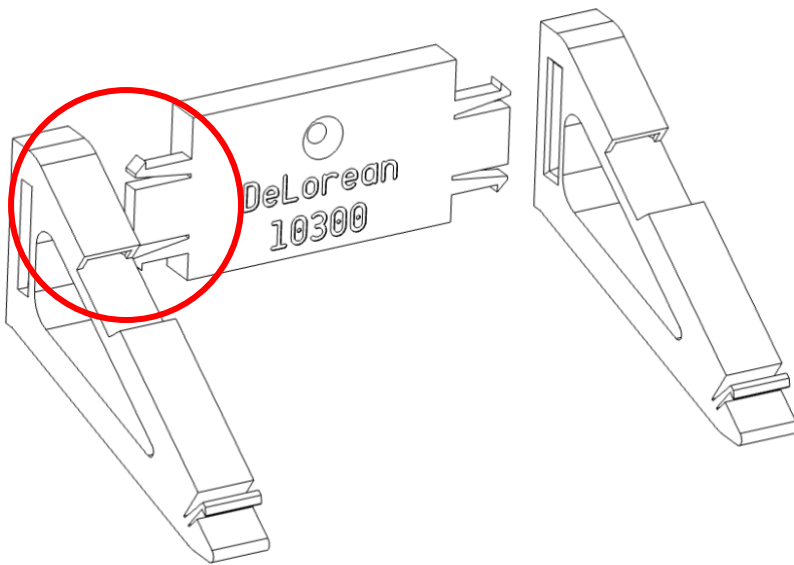
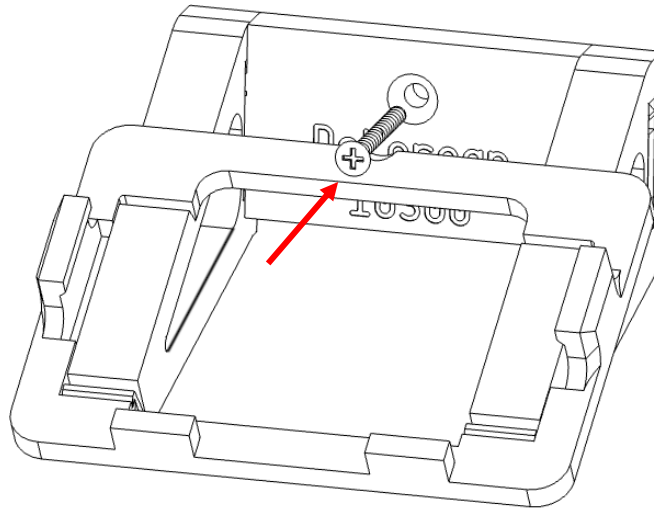

Use the included screw and wall plug to secure the wall mount. Do not overtighten the screw.

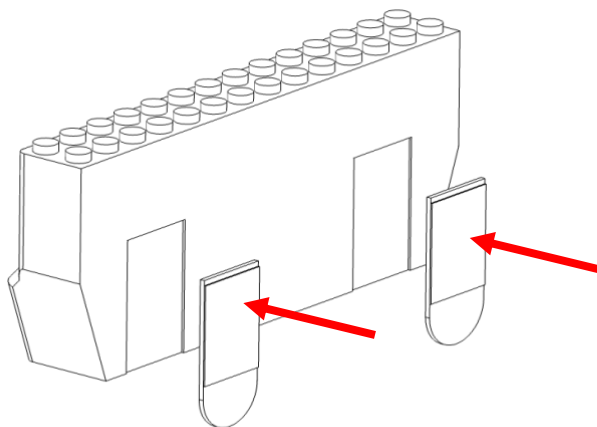

Secure the minifigure holder using the included 3M command strips

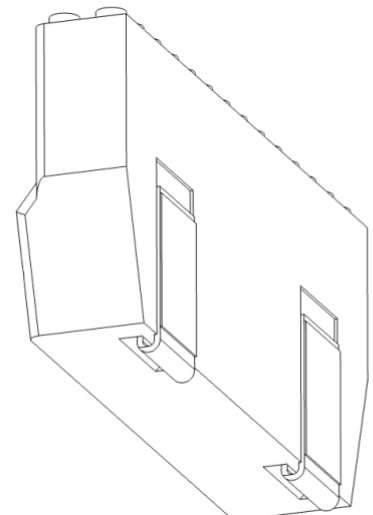

Minifigures and Info card

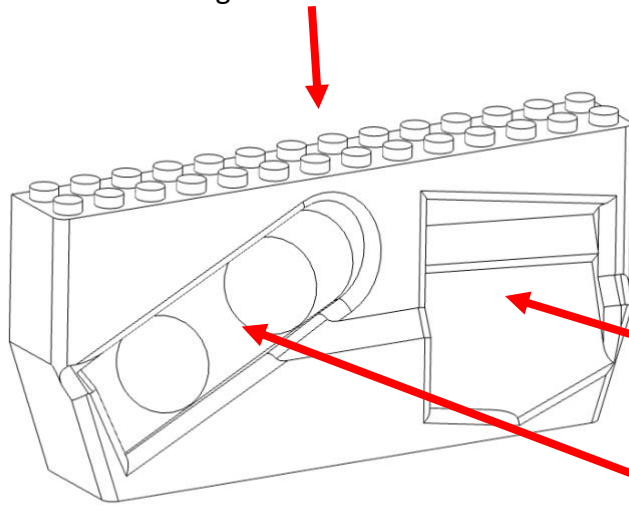

Plutonium case

Hover Board