

## Wall Mount Instructions Imperial Shuttle – (75302)

### Kit contents

- 1x Arm
- 1x Angled adaptor
- 1x Lego adaptor
- 1x Locking clip
- 1x Back plate
- 1x Minifigure mount
- 1x Minifigure mount lug
- 1x Wall plug (6x30mm)
- 1x Wall screw (4.5x50mm)
- 2x Small Command strip

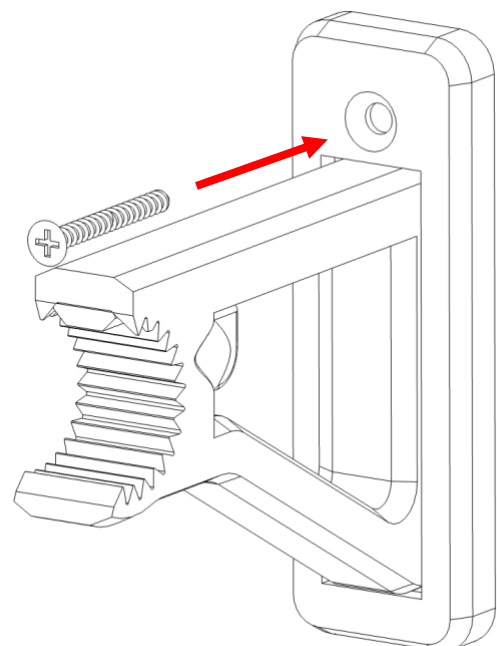
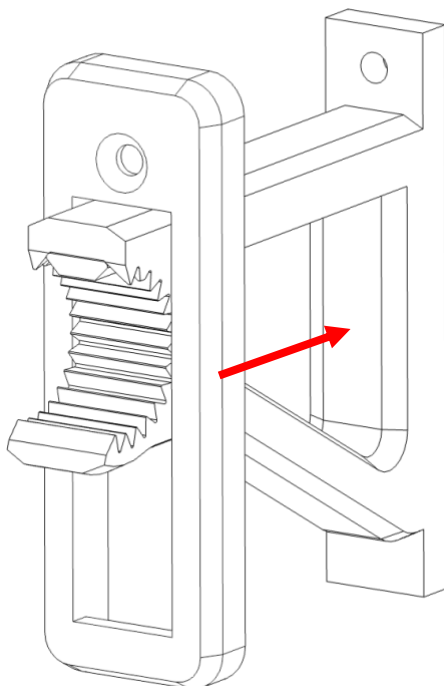
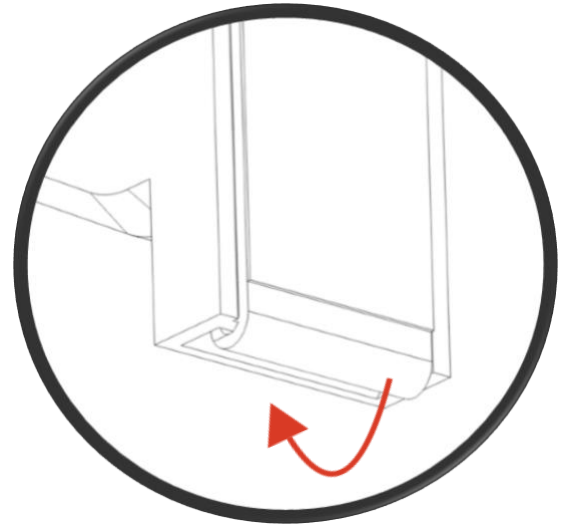
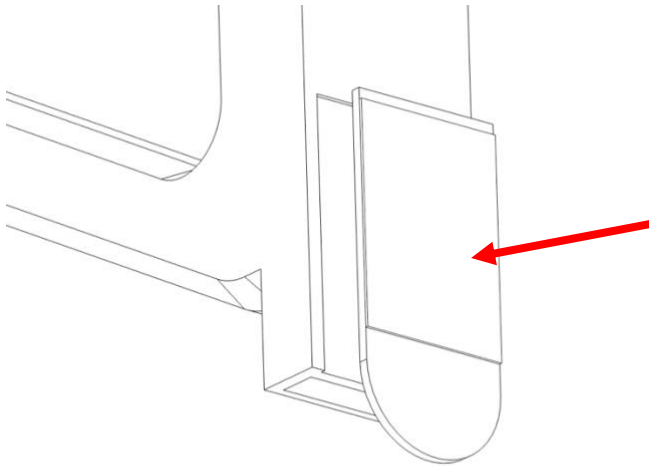
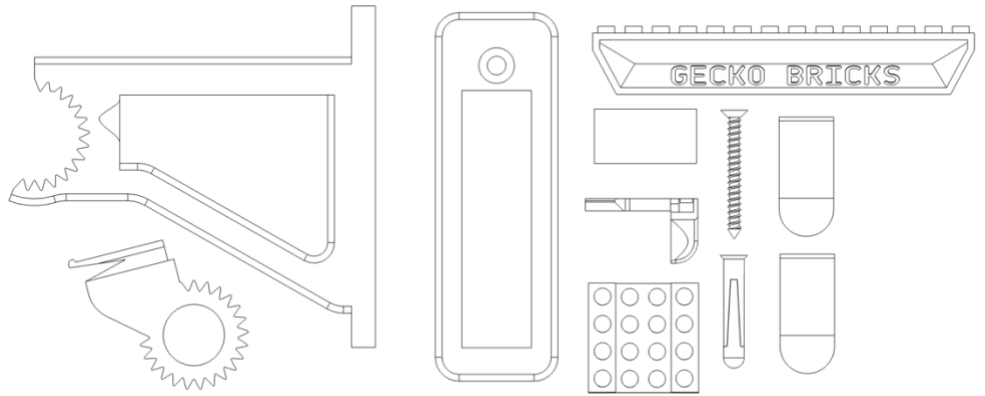

Careful not to over tighten the screw

## Wall Mount Instructions Imperial Shuttle – (75302)

You may adjust the angle of the set by repositioning the angled adaptor

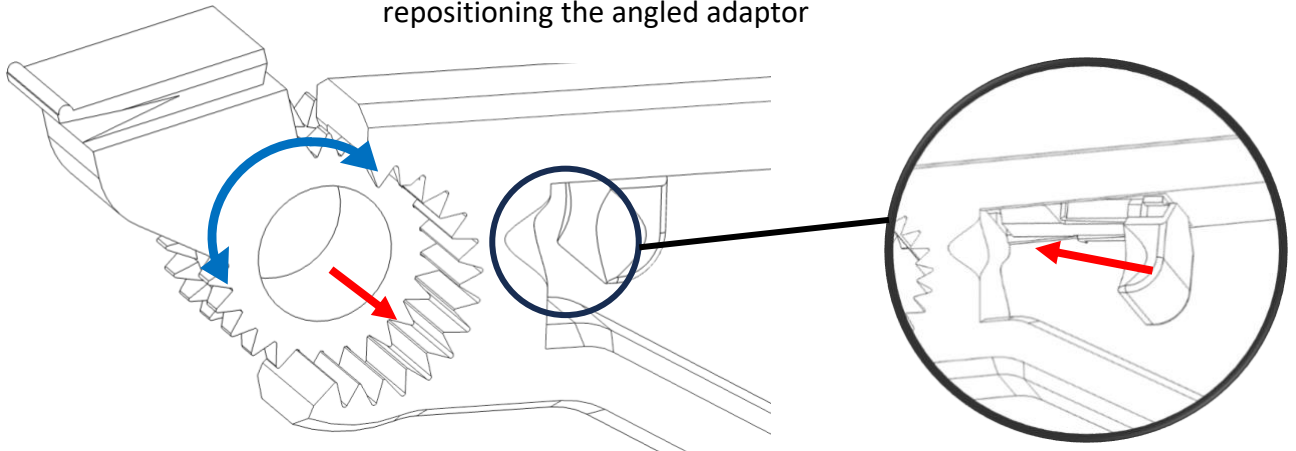

Lock the adaptor in place with the sliding clip

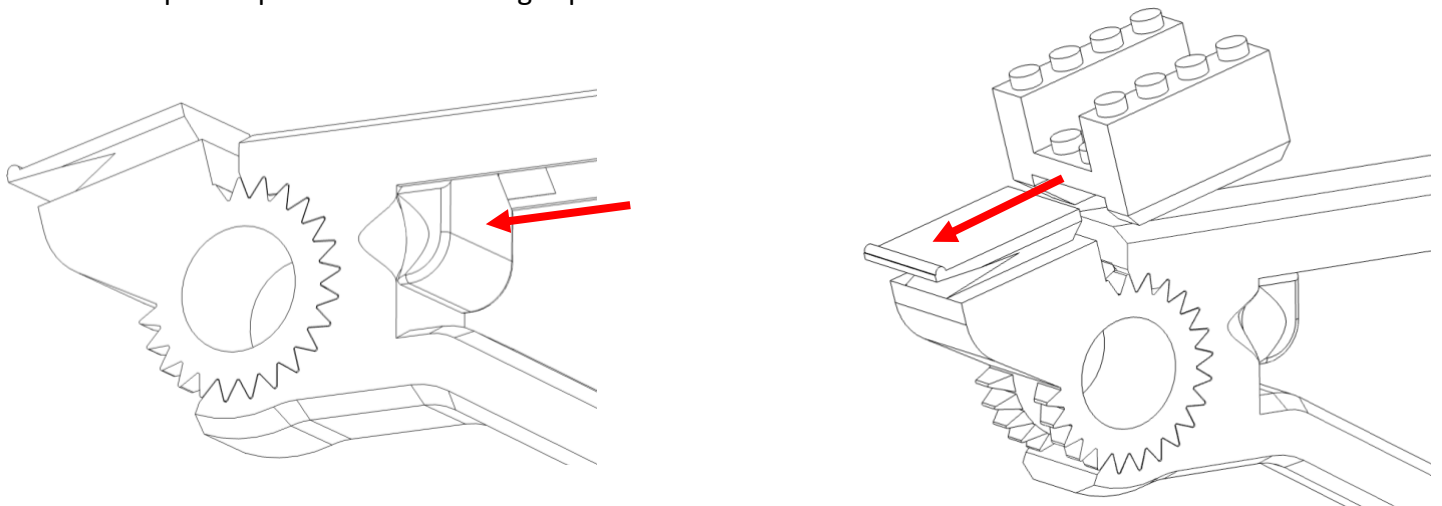

Connect the adaptor to the Lego set in the location shown

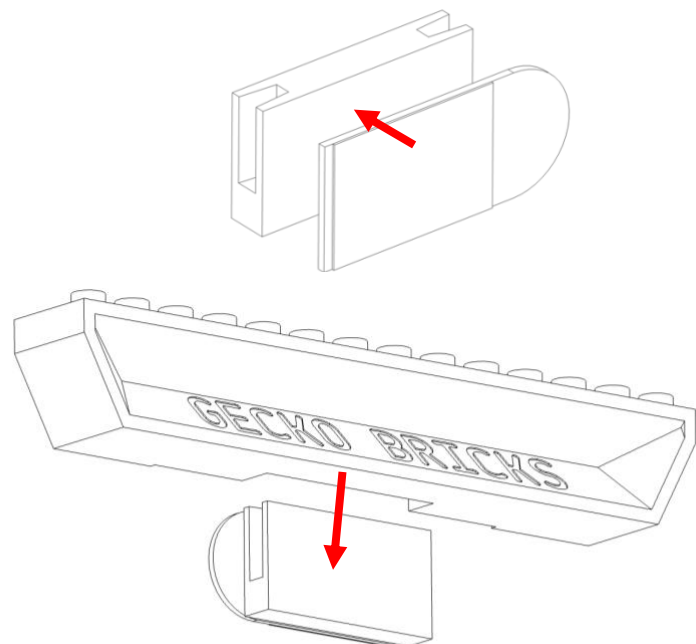
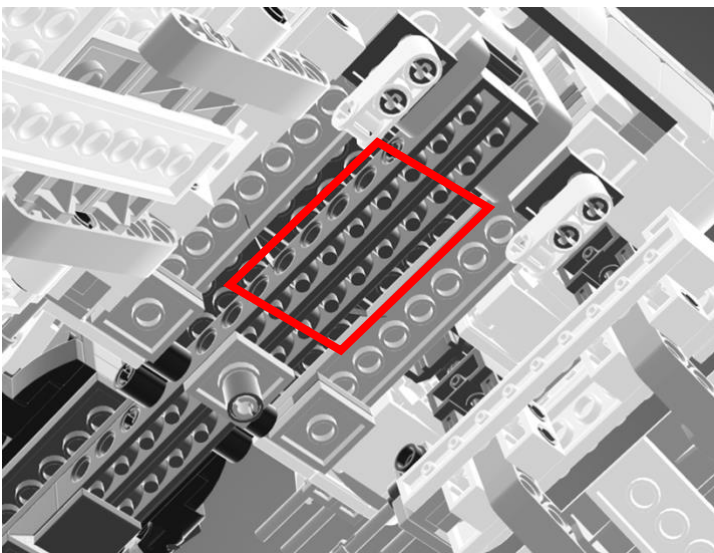

Attach the Minifigure mount lug to the wall first