

Wall Mount Instructions

Ahsoka's T6 Shuttle – (75362)

Kit contents

- 1x Arm
- 1x Angle adaptor
- 1x secondary arm adaptor
- 1x secondary arm
 - 2x clip in parts
- 1x Locking clip
- 1x Back plate
- 1x Minifigure mount
- 1x Minifigure mount lug
- 1x Wall plug (6x30mm)
- 1x Wall screw (4.5x50mm)
- 1x Small Command strip

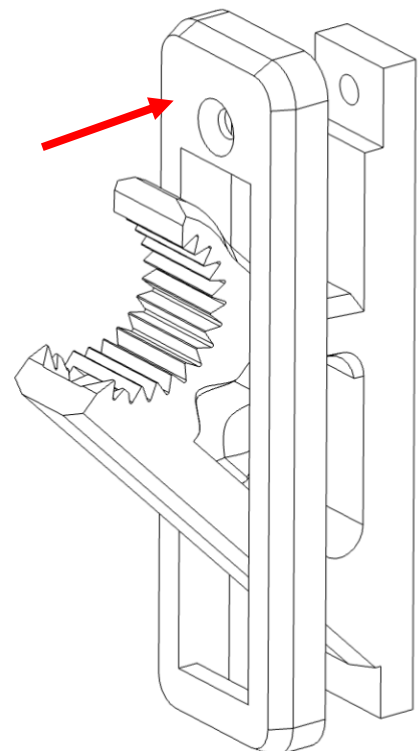
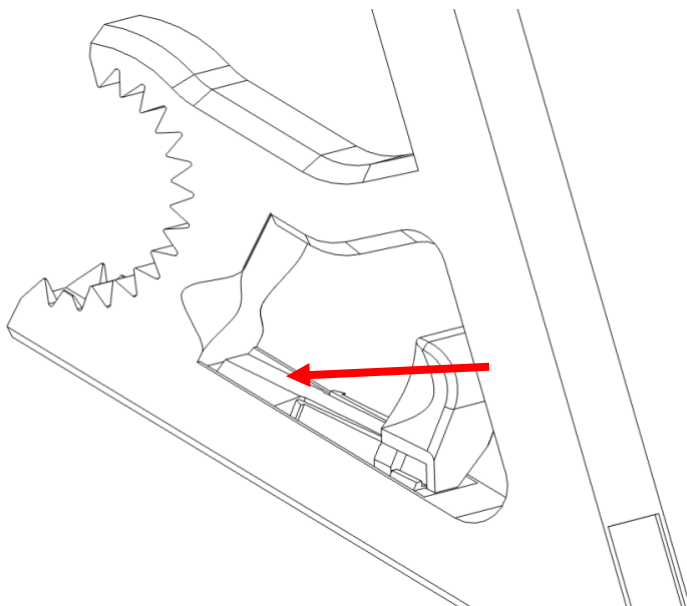
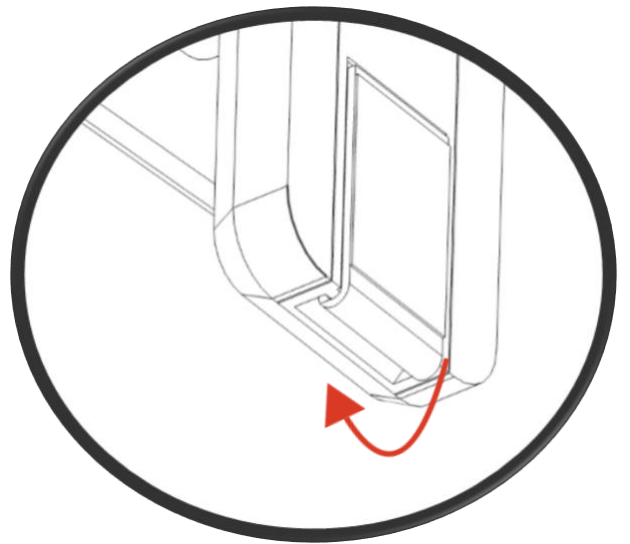
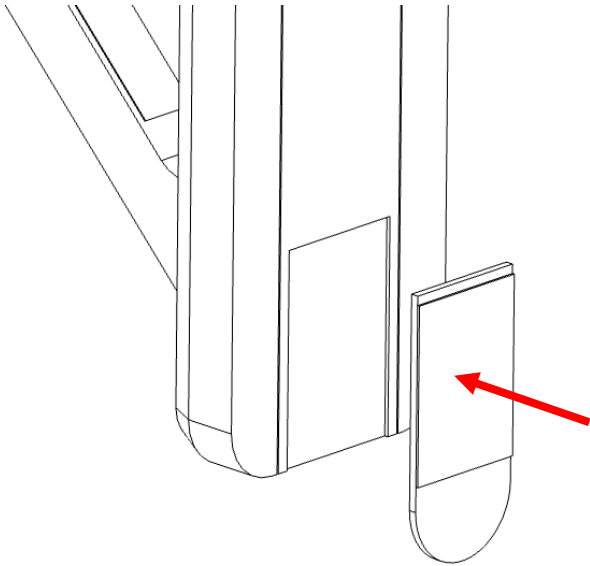
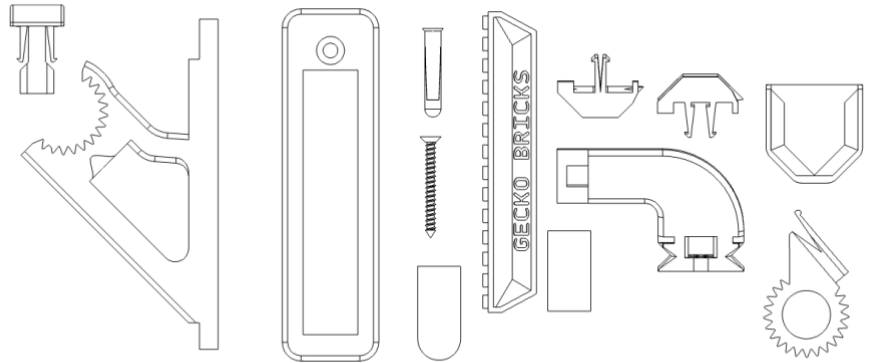

Wall Mount Instructions Ahsoka's T6 Shuttle – (75362)

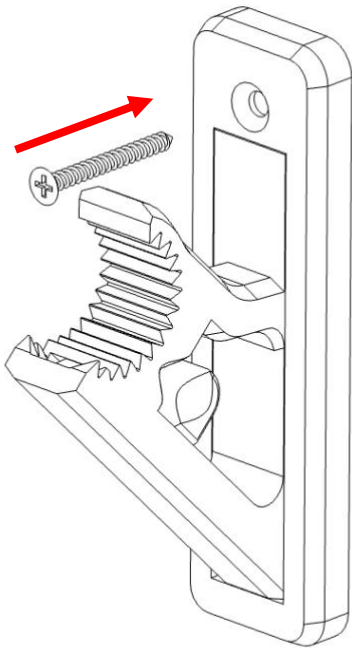

Careful not to over tighten the screw

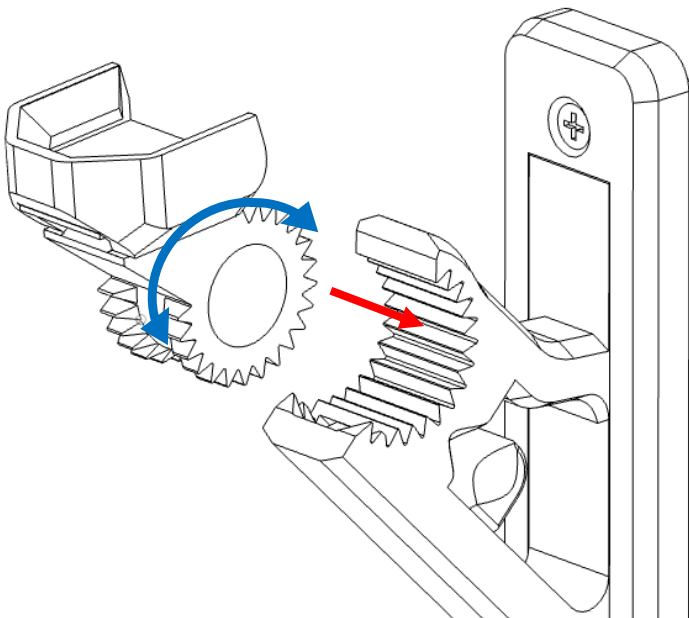
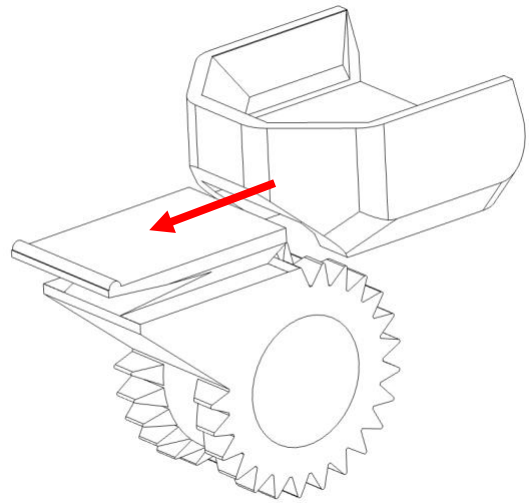

You may adjust the angle of the set by repositioning the angled adaptor

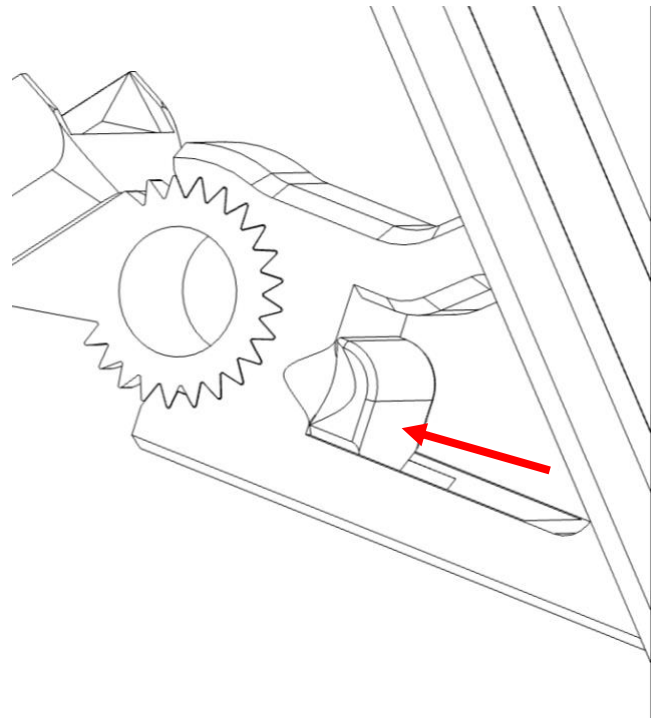

Lock the adaptor in place with the sliding clip

Wall Mount Instructions Ahsoka's T6 Shuttle – (75362)

Remove the Lego part as shown.

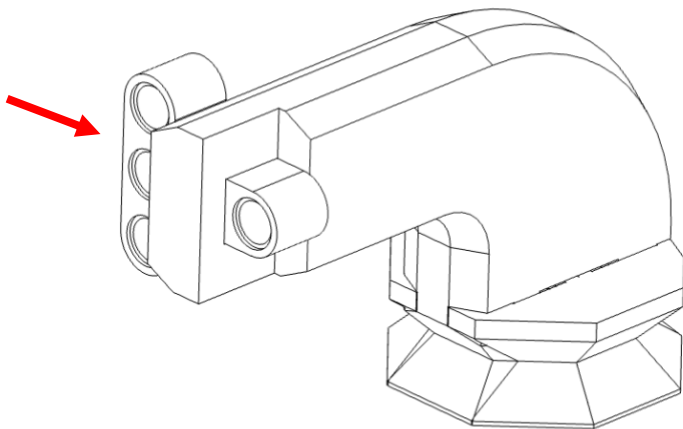
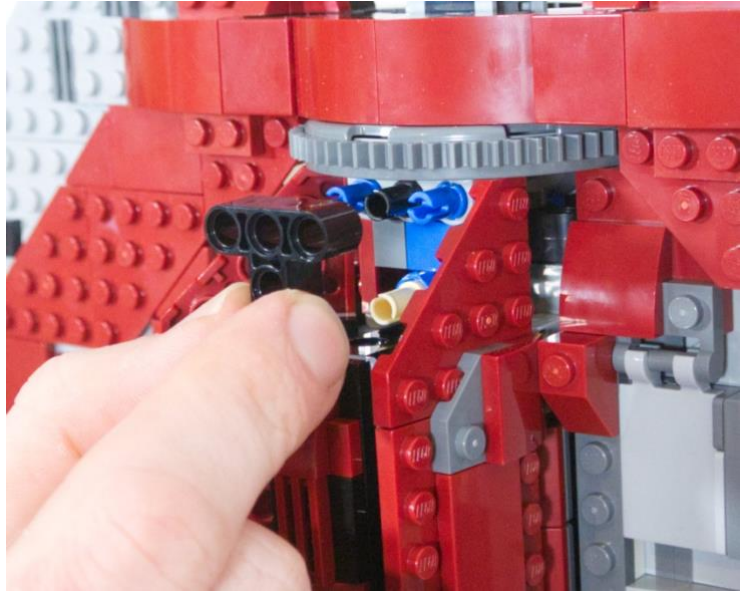
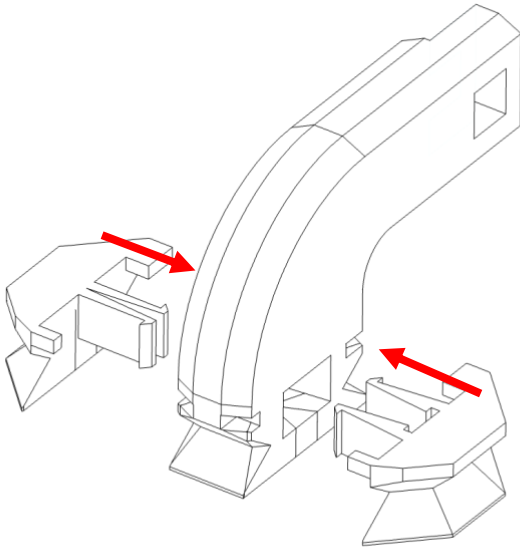

Ship right facing

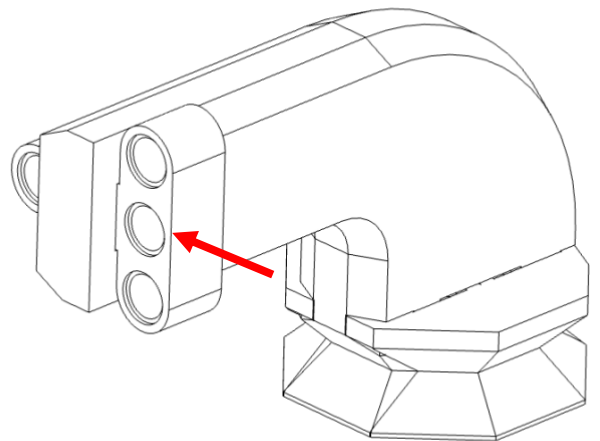

Ship left facing

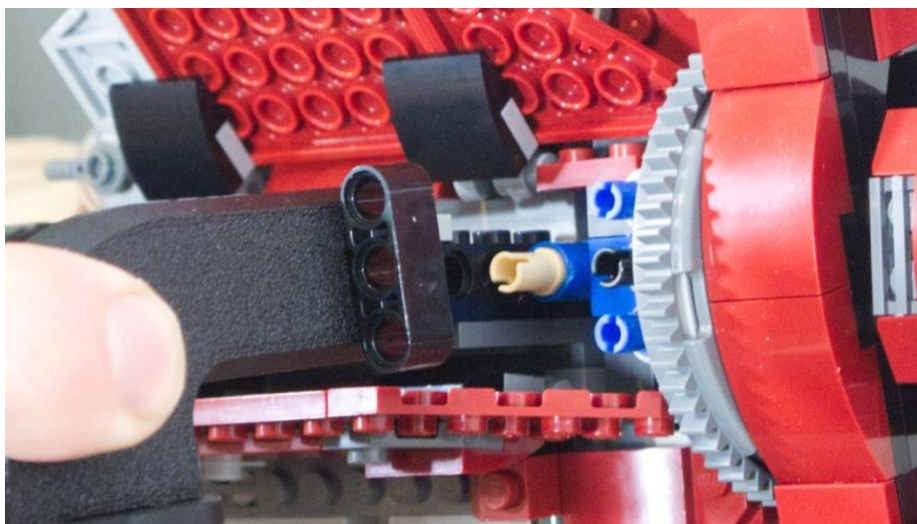

Mirrored process for both left and right facing

Wall Mount Instructions Ahsoka's T6 Shuttle – (75362)

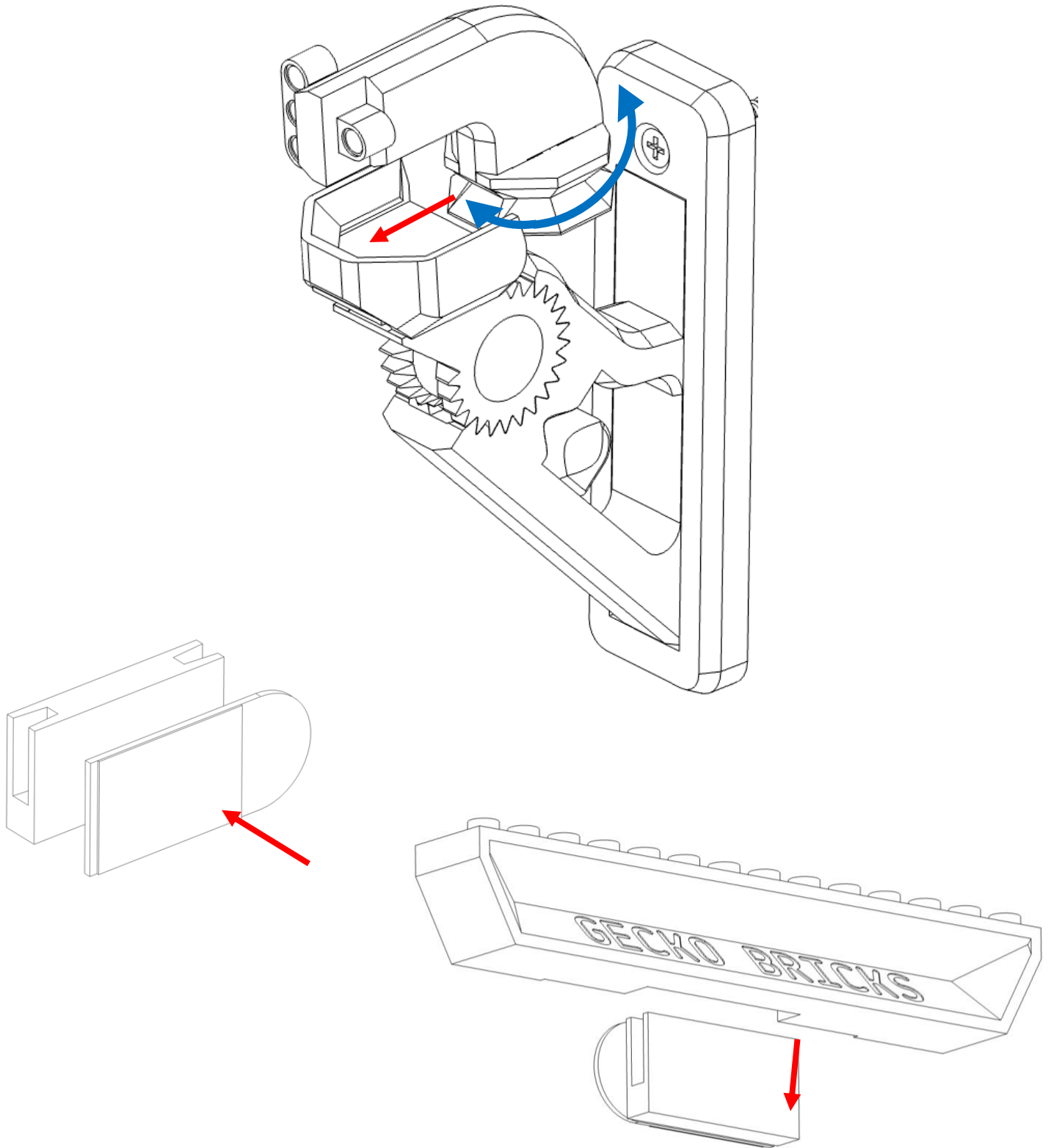

Attach the Minifigure mount lug to the wall first