

Horizontal Wall Mount Instructions For UCS Super Star Destroyer – (10221)

Horizontal wall mount

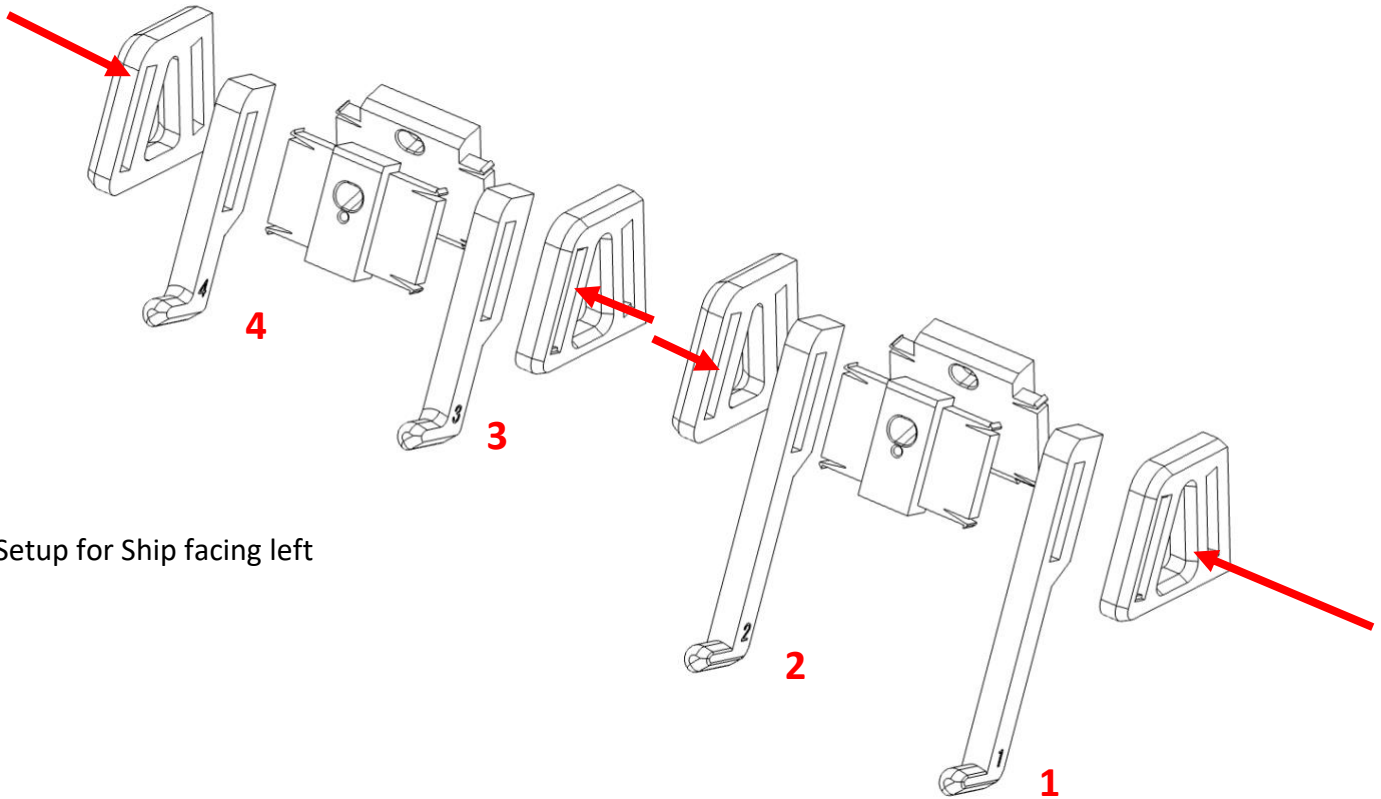

Setup for Ship facing left

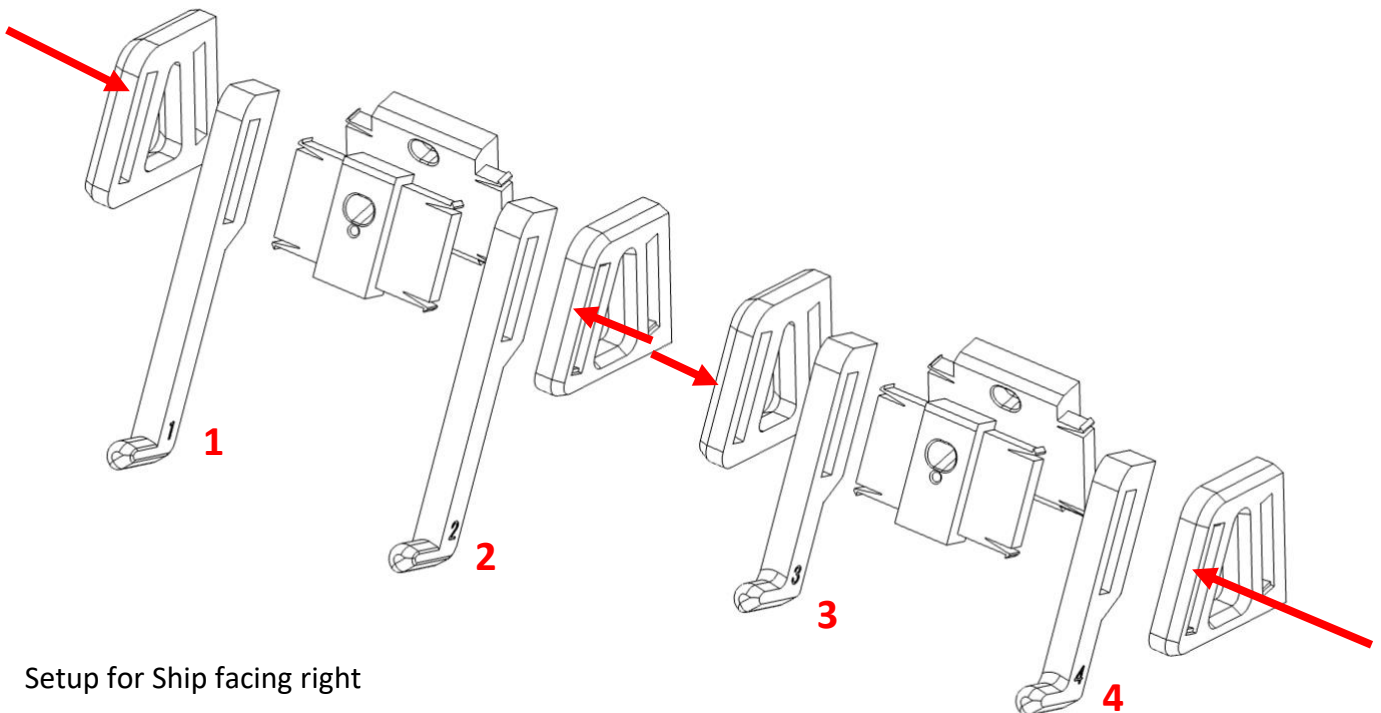

Setup for Ship facing right

Horizontal Wall Mount Instructions For UCS Super Star Destroyer – (10221)

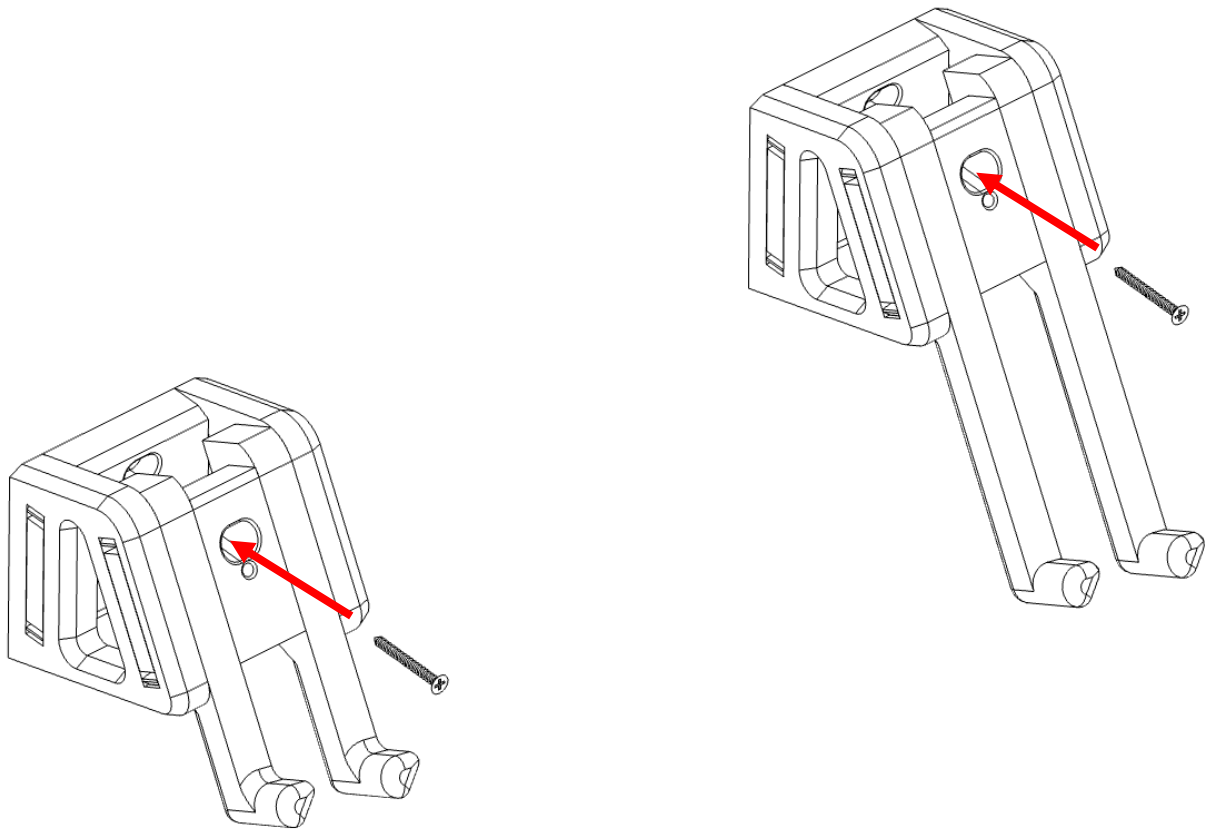
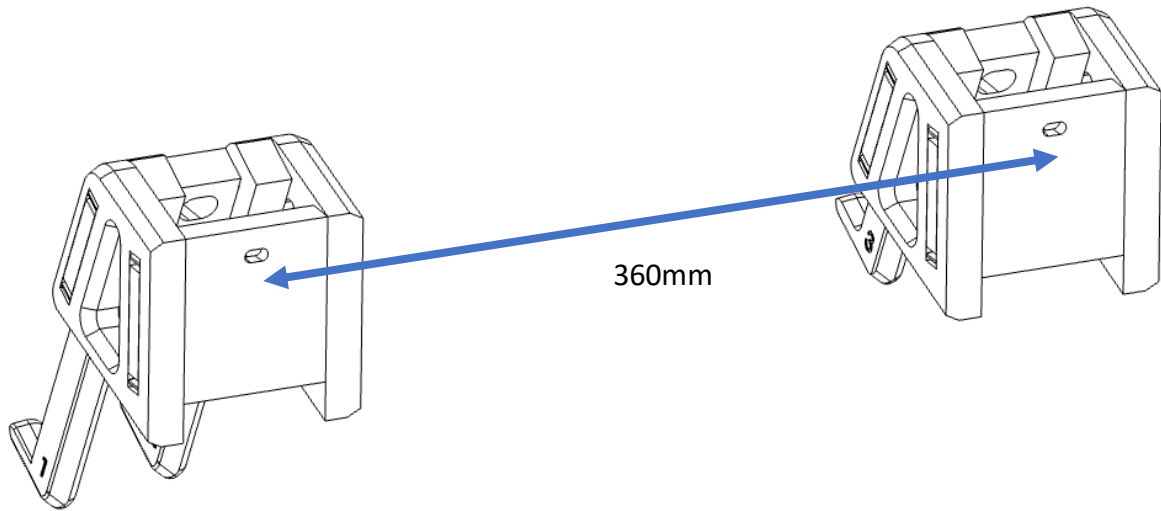

Adjustment left and right for any
misalignment in the next step

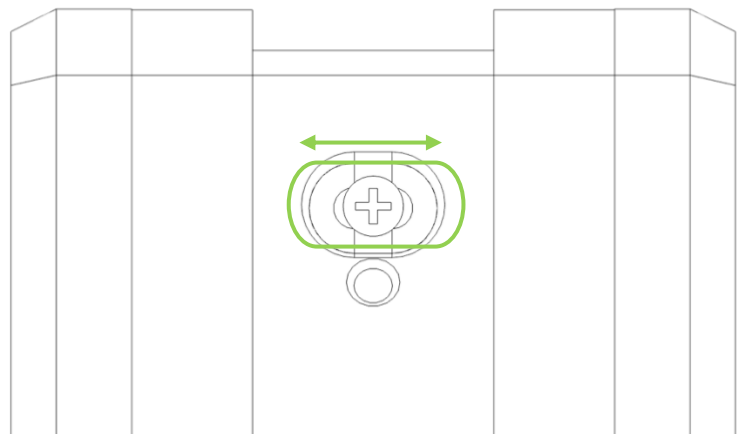

Horizontal Wall Mount Instructions For UCS Super Star Destroyer – (10221)

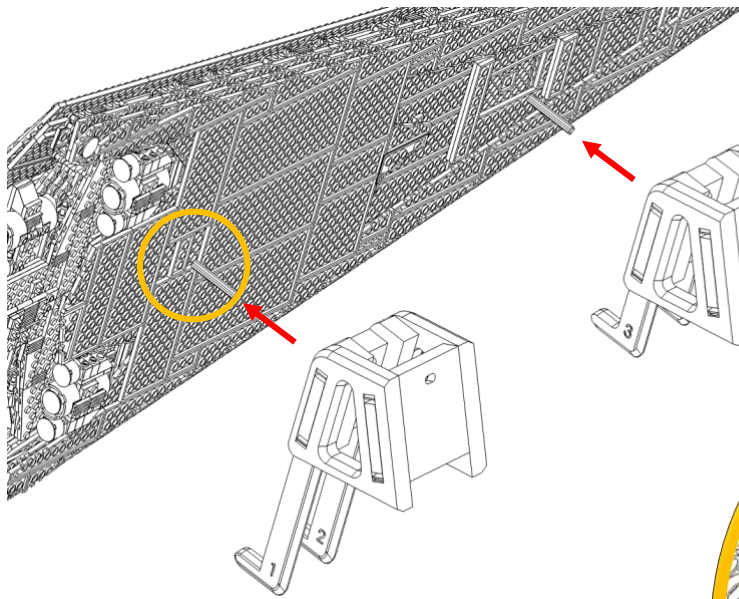

Insert the technic axles from the official Lego stand into the base of the ship.
(black at the front, grey at the rear)

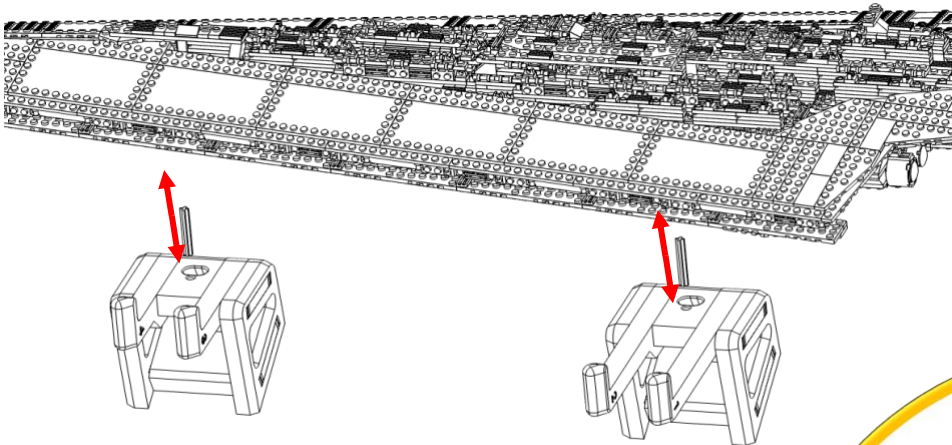

These axles then insert into the small holes on
the face of each wall mount.

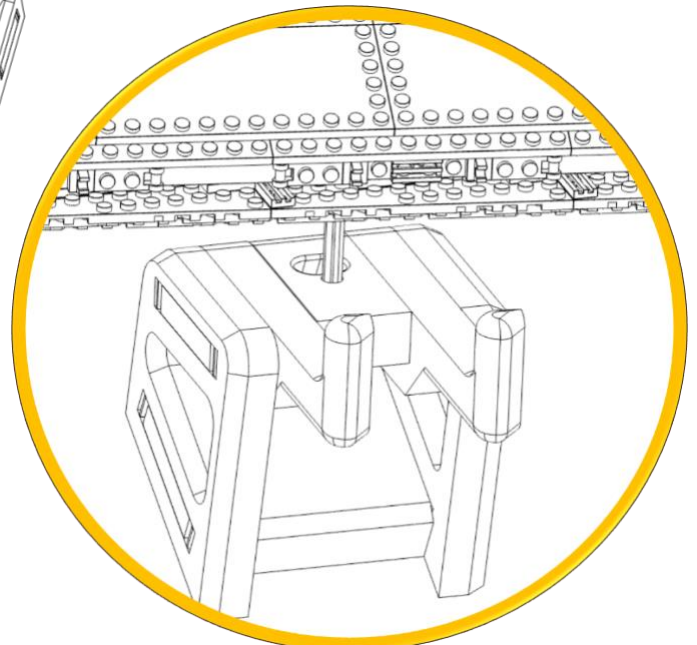

Horizontal Wall Mount Instructions For UCS Super Star Destroyer – (10221)

Use the provided 3M command strip to attach the info card holder in the position of your choice. Before placing the Lego card on, press firmly for 30 seconds.

